

- 1** SHD: Unscrew and remove long screws, cover, and SHD spacer.
 C-Mount: Remove screws and SHD adapter.

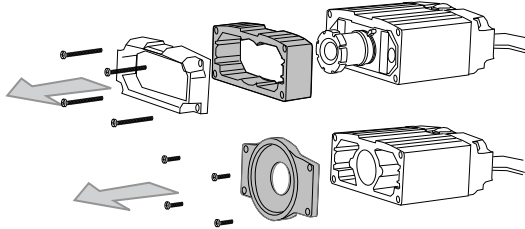

- 2** SHD: Unscrew and remove SHD lens.

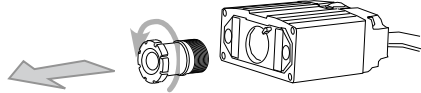

- 3** C-Mount: Replace light guide assembly (note orientation).

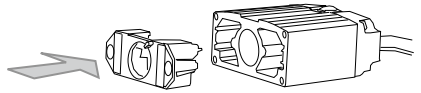

- 4** Install original DataMan 100 lens.

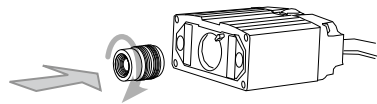

- 5**
1. Mount DataMan 100 at either 74 mm or 114 mm, measured from front of metal case to target symbol. Alignment guide is printed on back of this sheet.
 2. Connect DataMan 100 to Setup tool. Enable presentation mode.
 3. Adjust focus for maximum sharpness.

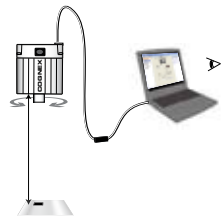

- 5** Align either 65 or 105 mark on lens ring to index mark, then carefully press focus flange onto lens. Avoid turning lens while pressing on focus flange.

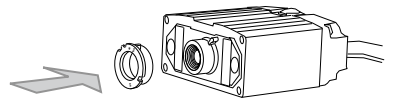

- 6** Install four original screws.
 Do not use long screws provided with SHD kit.

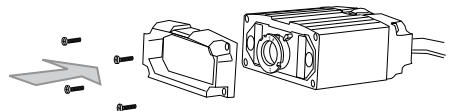

- 7** Tighten screws to 9 N-cm observing tightening order shown here.

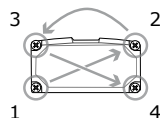

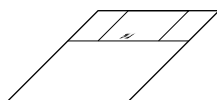
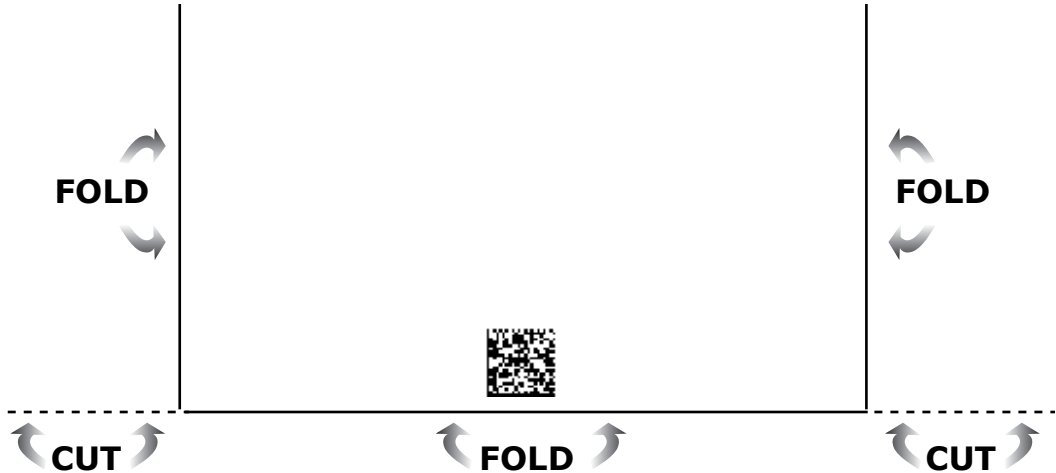

1

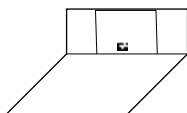

2

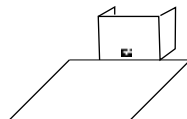

3

Align front of DataMan 100 case to this line (65mm focus setting).

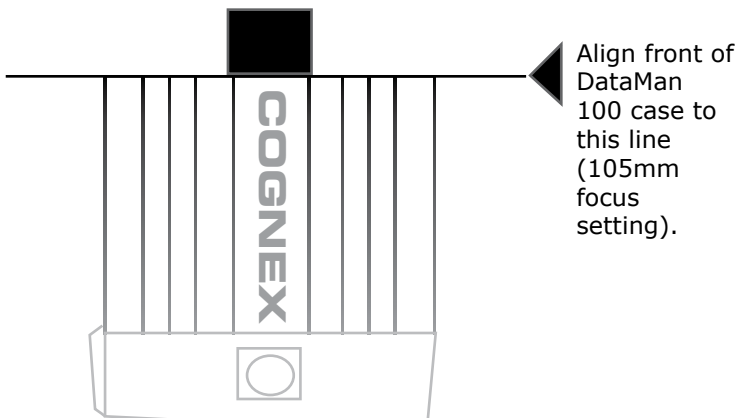

Distribué par :



Contact :
hvssystem@hvssystem.com

Tél : 0326824929
Fax : 0326851908

Siège social :
2 rue René Laennec
51500 Taissy
France

www.hvssystem.com